



Safety Regulations

The safety of our visitors, employees and contractors working on site is of major importance to our company. This brochure makes you familiar with the most important safety regulations in our plant. Please follow our safety instructions and ensure your own safety through adopting a responsible attitude. For any question regarding these rules please refer to your contact person.

Violations may result in a ban on future entering of the site!

General remarks

Before entering the site every visitor must sign in at the porter or in the visitor list at the reception desk. All vehicles are recorded by the porter with company name, car registration number and number of persons in the vehicle. Equally on leaving the site the visitor must sign out obligatory at the porter or in the visitor list respectively.

For visitors and contractors working on site special additional rules may be applicable (e.g. permit for work in EX-zones, welding work / work with risk of fire, work in confined space, work on roofs). Hence as part of the sign-in procedure before entering the site / start of any work further instructions will be given by the responsible contact person.

Entry and driving on the factory premises is at your own risk.

DIC Performance Resins accepts no liability for damages - of any kind whatsoever - arising from entering or driving on the factory premises during your stay.



Responsible Care
Verantwortung hat Zukunft

Behavior in Case of Alarm

In case of an alarm, always follow the instructions of the operating personnel or your contact person.

Intended alarm signals:

- **3 times rising and fading tone:**

Warning and alarming of fire brigade

- **3 minutes continuous tone:**

Evacuation – go to the nearest evacuation point (see map / backside)

Use the marked escape routes



Vehicles may NOT be put into service during an evacuation - the ignition key must be left in the ignition lock.

At the collection point, contact the assembly point manager (SPV with yellow vest).

- **All Clear:**

Is given by the fire-brigade at the assembly points.

- **15 sec. continuous tone (every Friday at 12:00 p.m.):**

Alarm drill

Rules for On Site Traffic



Use marked footpaths, always observe factory traffic!



Driving ban for passenger cars - except with written permission (request parking permit in advance)



Forklifts always have priority!



The road traffic regulations have to be observed. Use specified routes. Maximum top speed 10 km / h.



Storing, holding and parking on traffic routes is prohibited. Protective and escape routes, emergency exits, hydrants, gates and bottlenecks are always to be kept clear.

Drivers of trucks, tankers and delivery vehicles must remain in the vicinity of the vehicle during the waiting period. Deviations must be agreed with the local responsible person.

General Safety Instructions

For the entire factory area:



Unfounded stay at the factory premises (entry of buildings, roofs, storage areas, etc.) is prohibited.

Personal protective equipment –mandatory!



Protective Helmet (except office, lounges and laboratories)



Safety glasses (except office and recreation rooms)



ESD-Safety shoes (except office and recreation rooms)



Long sleeved clothing, long trousers (except office and recreation rooms)



Smoking and the use of open fire and lights is forbidden



Eating and drinking is prohibited on the factory premises



Alcohol and drug ban - Consumption and entrainment is not permitted!



Prohibition of non-ATEX conform cell phones, pagers, radios



Prohibition to take pictures or videos



Unauthorized manipulation of equipment (start-up of electrical appliances and machines of any kind) is prohibited.



In the case of special events (accident / near-miss, fire, explosion, substance leakage), contact the site personnel or the control room (Ext. 237).

Environmental Protection



The introduction of waste into the DPR collection system is not permitted.



It is forbidden to let pollutants (chemicals, solvents, etc.) get into the sewage system.

Orientation Map of the Plant

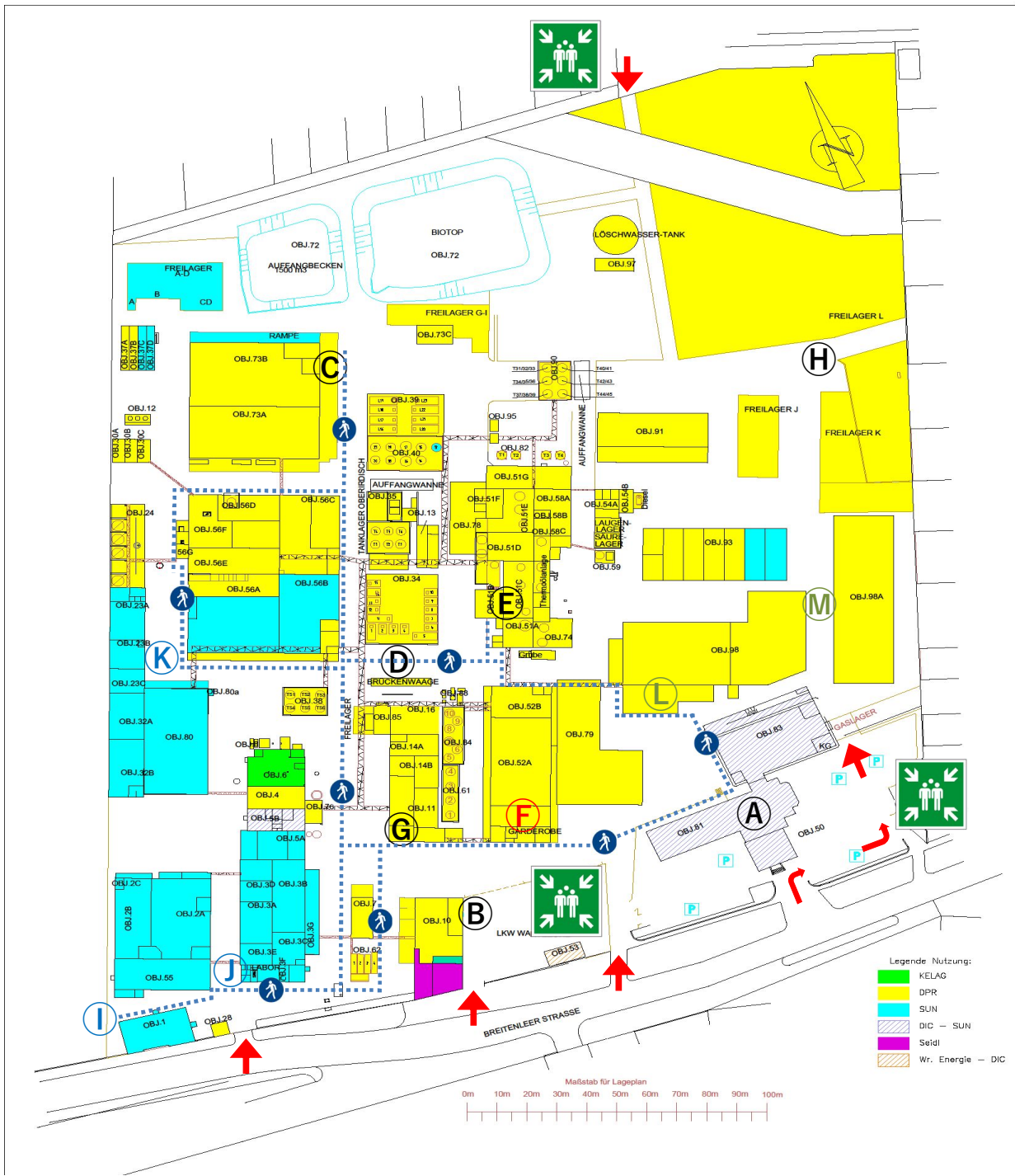

- | | |
|--|---|
| (A) Administration DPR (Phone +43/1/20110-0)
Administration SUN (Phone +43/1/8697606-0) | (I) SUN Chemical / Administration LI und SF |
| (B) Gatekeeper (Ext. 208) | (J) SUN Chemical / Warehouse LI |
| (C) Warehouse (Ext. 200) | (K) SUN Chemical / Warehouse SF |
| (D) Weighbridge | (L) DPR PPS / Office (+43/1/7340045-0) |
| (E) Control Room (Ext. 237) | (M) DPR PPS / Loading dock (+43 676 88028400) |
| (F) Company Fire Brigade | (Icon: Person walking) Footpath |
| (G) Maintenance | (Icon: Red arrow) Fire Brigade Access |
| (H) Waste / Disposal Area | (Icon: Green arrows) Collection Point |